

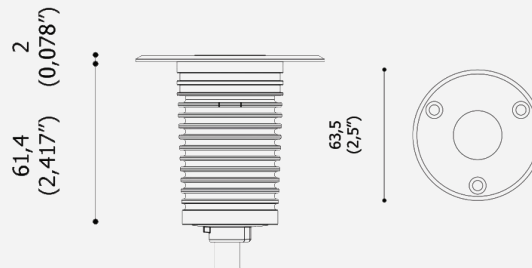

Ace

WHITE OR RGB- 24VDC
DRIVE OVER OR WALK OVER
316L STAINLESS STEEL SUBMERSIBLE OR DRY
OPTIONAL INGROUND HOUSING

ACE is designed for in-ground pavers, accent lighting of facades, small trees, water features, swimming pools and fountains. It has been certified for drive over or walk over designs such as streets, public squares, hotels, shopping malls, driveways and walkways.



Specification

Description

Input voltage	24VDC
Output power	2W-white, 4W RGB
Luminous flux output	105 TO 130 lm/W
Rendering Index	>80
Lens Degree options	honeycomb (8°)-9°,24°,45°,satin diffused 97°, transparent 111°
Security	TORX-Anti-vandal screws
Material	316L STAINLESS STEEL -silicone gasket - tempered flat glass
Face ring	316L Stainless Steel
Color options	2700K,3000K,4000K,RGB
Chromatic Selection	2 step MacAdam
LEDs operating life	> 50,000 hours
IP rating	IP68 - CERTIFIED SUBMERSIBLE OR DRY
Load resistance	Drive over up to 3000kg (6,613lbs)
Certifications	cULus CSA22.2 no.89 - including swimming pools and splash pads
Installation	Ground or wall recessed with housing Housing kits for recessing must be ordered separately
Weight	260g (9.17oz)

