

# UL316R-27

**27W (9 X 3W) - RGB-DMX - 12AC/24DC**  
**SUBMERSIBLE OR DRY**  
**CAST 316L SS**  
**REPLACEABLE LEDS**  
**UL CERTIFIED FOR SWIMMING POOLS**



Optional insert  
 1 1/2" FNPT x 1" FNPT

RGB-DMX or White  
 Cast 316L Stainless Steel - Replaceable LEDs  
 Submersible or Dry Installation  
 SS Flush Mount Mirror Polish Face Ring  
 Optional threaded center adapter to fit 1" nozzle, 1 1/2" pipe

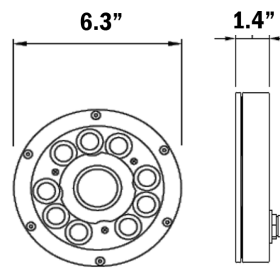

Specification	Description
Input voltage	12VAC or 24VDC
Output power	27 watts (9X3W)
Rendering Index	>70rA (warm white)
Beam angle	10°, 30, 45
LEDs	<b>Replaceable</b> - Internal Driver
Material	<b>Cast 316L Stainless Steel</b> Silicone gasket - tempered glass lens
Face ring	316L SS Flush Mount
Color options	RGB-DMX
White	CREE-XPE - 2700K to 6500K
LEDs operating life	> 50,000 hours
IP rating	<b>IP68 - Certified Submersible or Dry</b>
Cable	9 FEET - SOW 18/5 Longer cable can be ordered
Dimensions	Diameter 6.3"x 1.4" center opening 1.85"
Certifications	cULus CSA22.2 no.89 - including swimming pools and splash pads - meets 680 standards
Installation	Submersible or Dry - optional SS threaded adapter to fit 1" nozzle, 1 1/2" pipe

