

UL316R-24

24W (6 X 4W) - RGBW-DMX - 12AC/24DC
SUBMERSIBLE OR DRY
CAST 316L SS
REPLACEABLE LEDS
UL CERTIFIED FOR SWIMMING POOLS



Optional insert
 1 1/2" FNPT x 1" FNPT

RGBW-DMX
 Cast 316L Stainless Steel - Replaceable LEDs
 Submersible or Dry Installation
 SS Flush Mount Mirror Polish Face Ring
 Optional SS threaded center adapter to fit 1" nozzle/ 1 1/2" pipe

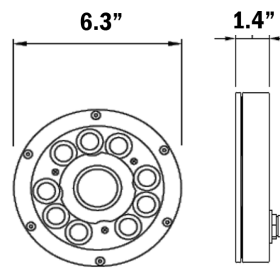

Specification	Description
Input voltage	12VAC or 24VDC
Output power	24 watts (6X4W) - RGBW-DMX
Rendering Index	>70rA (warm white)
Beam angle	15°, 30 - Bead lens 20, 30, 45
LEDs	Replaceable - Internal Driver
Material	Cast 316L Stainless Steel Silicone gasket - tempered glass lens
Face ring	316L SS Flush Mount
Color options	RGB-DMX
White	CREE-XPE - 2700K to 6500K
LEDs operating life	> 50,000 hours
IP rating	IP68 - Certified Submersible or Dry
Cable	9 FEET - SOW 18/5 Longer cable can be ordered
Dimensions	Diameter 6.3"x 1.4"
Certifications	cULus CSA22.2 no.89 - including swimming pools and splash pads - meets 680 standards
Installation	Submersible or Dry- optional SS threaded center adapter to fit 1" nozzle, 1 1/2" pipe

